

USER MANUAL



Thank you for choosing Better Bathrooms.
Please read this manual before installing your product
and keep for future reference.

better 
bathrooms

Post Formed Vanity Worktops

ONTMWT1500

VANOWT1500

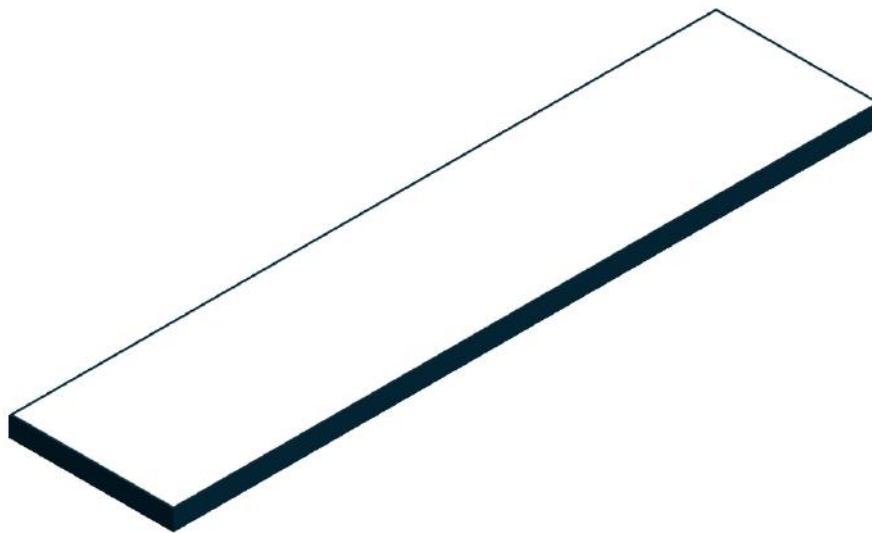

- **Single-person assembly**
- **Tools required**
- **We always recommend using professional tradespeople to install your product**

Version 2
04/12/2025

Congratulations on your purchase

And welcome to our growing gang of savvy shoppers

We're on a mission to bring you extraordinary bathroom products, for less. From modern to traditional style ceramics, plus the gorgeous fixtures, fittings and furniture to match. So, you can fall in love with your space every single day.

As one of the UK's largest independent bathroom stores, we've received countless awards; including the National Business Awards UK, the Digital Entrepreneur Awards and being placed on The Sunday Times Fast Track 100.

We hope your new product goes above and beyond your expectations. However, should any problems occur, please:

- log in to your account and contact our customer services team via your self-serve portal – betterbathrooms.com/CustomerAccount/Login
- contact us via betterbathrooms.com/content/contact-us

Important information

- Please read these instructions thoroughly and retain for future reference
- Always check for pipes and cables before drilling
- Max Load Wight = 64kg

Contents

- Technical Drawing
- Tools Required
- Installation Notices
- Installation Instructions
- Maintenance, Care & Cleaning

Technical Drawing

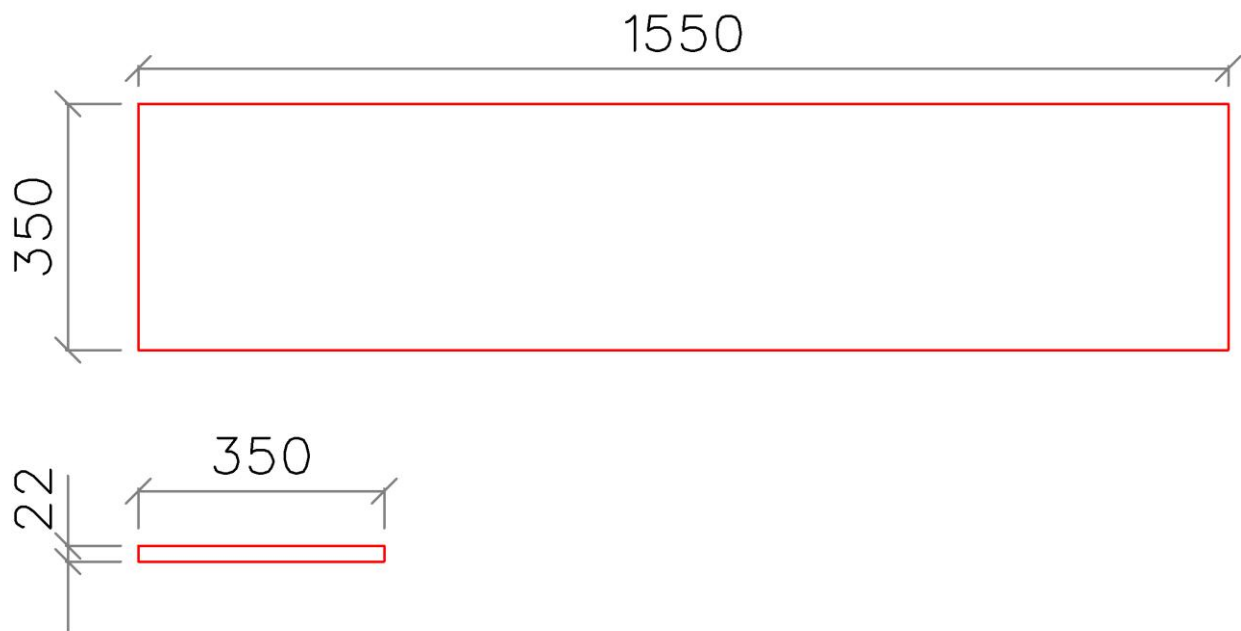

Tools Required

- **Tape measure:** For accurate measuring of the worktop space.
- **Spirit level:** To ensure the worktop is perfectly horizontal.
- **Saw or jigsaw:** For cutting the worktop to size.
- **Drill:** For making holes for screws or for starting points to cut out sections.
- **Laminate strips:** If you're working with laminate worktops, these will finish the edges.
- **Adhesive:** For bonding the worktop to the cabinets or for laminate strips.
- **Silicone sealant:** To seal joints and prevent water ingress.
- **Sandpaper:** For smoothing cut edges.
- **Pencil:** To mark cutting lines on the worktop.

Installation Notices

Before fitting:

Please peel back the protective film to check for colour matching before commencing installation. It can easily be pushed back after checking the match and before commencing the fit.

No refitting charges will be accepted for shade variation after fitting has been completed.

Important:

Always double check and measure twice

Thoroughly inspect the worktop for any transit damages and marks prior to fitting.

Installation Instructions

Once you are sure measurements are exact use a pencil to mark laminate. Ensure you allow for any edging to be added.

Cut out basins and bowls:

Use the pattern supplied with the sink to mark out. All cut Edges must be sealed with water resistant materials, like Polyurethane or silicone etc. Paying particular attention to

Semi recessed bowls:

Silicone sealant must go all the way under the front edges of the worksurface where the bowl cuts into the bathroom top.

This bathroom worksurface has been designed to sit on a base unit or supported by floor to worksurface legs. Wall mounting free standing installation is not recommended, if this is required you must ensure that you use appropriate fixings/brackets depending on the type of wall and the potential load you are expecting it to safely hold.

Cutting

When using a handsaw, cut through from laminate surface. A sharp fine tooth, 10/12 teeth per inch saw is ideal for a perfect cut.

When using a power saw, cut from underside of worktop. With the worktop face down follow your marking so that the saw teeth cuts towards the laminate surface.

Worktop to be cut to size, with a 5mm overhang allowed in the instance the worktop/units are not sitting flush to the wall

Maintenance, Care & Cleaning

IMPORTANT: The below instructions apply to the worktop only! Please see separate maintenance instruction for fitted furniture.

Light Stains/Dirt

- Dry or damp paper towels, a cloth or sponge

Normal Stains/Dirt

e.g. fat, oil and dirt particles, finger-marks, lime deposits, rust, juice, coffee, tea, wax, blood, universal marker etc

- With a cloth or soft nylon brush and washing powder, soft soap, toilet soap or washing-up liquid. If necessary, leave for a while and then wipe clean.

Heavy Stains/Dirt

e.g. discolouration through long exposure to tea, coffee, fruit juice etc.

- With washing powder and household bleach (but do not repeat too often).

e.g. lead pencil, felt-tip pens, marker and ball-point pens, lipstick, crayons, wax, shoe polish, nicotine, nail varnish.

- Methylated spirits, petroleum spirit, perchloroethylene. Read the manufacturer's instructions carefully!

e.g. paint (water or solvent based paints, two-component paints, spray paints), varnish stains, printing ink

- Remove two-component paints immediately.
- Methylated spirits, petroleum spirit, perchloroethylene. Read the manufacturer's instructions carefully!

e.g. adhesives (water-based, dispersion)

- With water or an organic solvent

e.g. two-component adhesives, urea resin, melamine, phenolic resin

- Remove immediately. Do not allow to harden!

Gloss Surfaces

- General cleaning of the surface requires only a damp cloth and a mild detergent or non-abrasive cleaner diluted in warm water.
- Abrasive scouring powders, creams and even polishes should all be avoided.
- Buff the surface after cleaning with a soft cloth.

A GLOSS SURFACE WILL SHOW SCRATCHING, CUTS, HEAT DAMAGE, MORE EASILY THAN A STANDARD FINISH SURFACE.

Care Instructions

Always avoid excess water around areas where there are cut outs, as these are potential weak areas.

Always wipe away excess standing water immediately.

Do not leave any damp cloths, sponges or anything wet etc. on the top front edge, as this top front edge is a potential weak area to water ingress.

For more information

- visit betterbathrooms.com
- email customerservices@buyitdirect.co.uk
- call 0330 390 3062
- write to Trident Business Park, Neptune Way, Huddersfield, HD2 1UA

**better
bathrooms** 

Part of the BuyItDirect Group